

Welcome to NC Quick Pass! You are now one step (well, actually two steps) closer to enjoying savings of up to 35% on tolls in North Carolina!

Your new NC Quick Pass transponder must be adhered to the interior windshield according to the instructions below in order to ensure its proper operation. It is recommended to clean and dry the interior surface prior to installing your transponder.



1 Determine the correct location for your transponder, considering the following (as applicable):

- As close to the center of the windshield as possible;
- Four (4) inches away from the top edge of your windshield; and
- Four (4) inches away from any electronic device* mounted on your windshield.

2 Carefully remove transponder from the liner and place on the windshield in the appropriate location using the ruler below as a guide.

! Once installed, the transponder cannot be removed without damaging it.

***Electronic devices can interfere with the operation of your transponder.**

- If you have electronic devices in the rearview mirror such as GPS units, radios, and navigational compasses, place the transponder four (4) inches from the stem of the mirror that is fixed to the windshield.
- If you have electronic devices behind the rearview mirror, mounted or integrated into the windshield such as rain or speed sensors, place the transponder four (4) inches from the device, while remaining four (4) inches from the roofline.

? Need help? Please visit an NC Quick Pass Customer Service Center, and a representative will be happy to verify the proper installation and operation of your transponder.

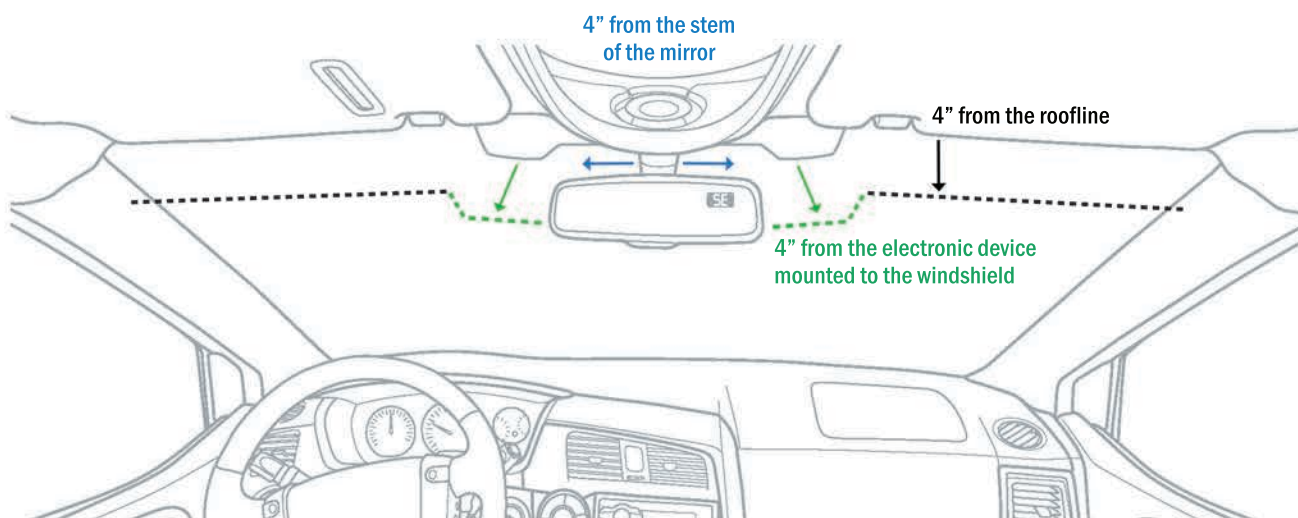

Manage your account at ncquickpass.com

NC Quick Pass Customer Service Center • 200 Sorrell Grove Church Road, Suite A • Morrisville, NC 27560-9543

Business Hours: Monday - Friday: 9 AM - 5 PM Saturday: 9 AM - 2 PM

Web: www.ncquickpass.com • Phone: 1-877-7MY-PASS (1-877-769-7277) • Fax: (919) 388-3279